

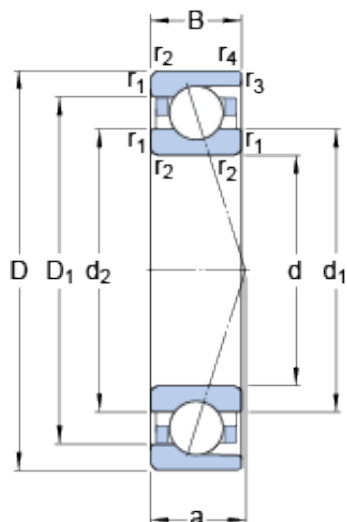

NUP BEARING LTD



35 mm x 47 mm x 7 mm skf 71807 ACD/P4 Super-precision Angular contact ball bearings

Bearing No. 71807 ACD/P4

71807 ACD/P4 Bearing 2D drawings and 3D CAD models

| | |
|---|-------------|
| Size | 47x35x7 mm |
| Bore Diameter | 47 mm |
| Outer Diameter | 35 mm |
| Width | 7 mm |
| d | 35 mm |
| D | 47 mm |
| B | 7 mm |
| d ₁ | 39.1 mm |
| d ₂ | 39.1 mm |
| D ₁ | 43.1 mm |
| r _{1,2} - min. | 0.3 mm |
| r _{3,4} - min. | 0.15 mm |
| a | 13.1 mm |
| d _a - min. | 37 mm |
| d _b - min. | 37 mm |
| D _a - max. | 45 mm |
| D _b - max. | 46.2 mm |
| r _a - max. | 0.3 mm |
| r _b - max. | 0.15 mm |
| d _n | 39.5 mm |
| Basic dynamic load rating - C | 4.4 kN |
| Basic static load rating - C ₀ | 4 kN |
| Fatigue load limit - P _u | 0.173 kN |
| Limiting speed for grease | 26000 r/min |



NUP BEARING LTD

| | |
|------------------------------------|----------------------|
| Lubrication | |
| Limiting speed for oil lubrication | 40000 mm/min |
| Ball - D_w | 3.175 mm |
| Ball - z | 26 |
| G_{ref} | 0.28 cm ³ |
| Calculation factor - e | 0.68 |
| Calculation factor - Y_2 | 0.87 |
| Calculation factor - Y_0 | 0.38 |
| Calculation factor - X_2 | 0.41 |
| Calculation factor - Y_1 | 0.92 |
| Calculation factor - Y_2 | 1.41 |
| Calculation factor - Y_0 | 0.76 |
| Calculation factor - X_2 | 0.67 |
| Preload class A - G_A | 39 N |
| Preload class B - G_B | 115 N |
| Preload class C - G_C | 230 N |
| Calculation factor - f | 1.18 |
| Calculation factor - f_1 | 0.97 |
| Calculation factor - f_{2A} | 1 |
| Calculation factor - f_{2B} | 1.08 |
| Calculation factor - f_{2C} | 1.15 |
| Calculation factor - f_{HC} | 1 |
| Preload class A | 76 N/micron |
| Preload class B | 119 N/micron |
| Preload class C | 161 N/micron |
| d_1 | 39.1 mm |
| d_2 | 39.1 mm |
| D_1 | 43.1 mm |
| $r_{1,2}$ min. | 0.3 mm |



NUP BEARING LTD

| | |
|--|----------------------|
| $r_{3,4}$ min. | 0.15 mm |
| d_a min. | 37 mm |
| d_b min. | 37 mm |
| D_a max. | 45 mm |
| D_b max. | 46.2 mm |
| r_a max. | 0.3 mm |
| r_b max. | 0.15 mm |
| d_n | 39.5 mm |
| Basic dynamic load rating C | 4.36 kN |
| Basic static load rating C_0 | 4.05 kN |
| Fatigue load limit P_u | 0.173 kN |
| Attainable speed for grease lubrication | 26000 r/min |
| Attainable speed for oil-air lubrication | 40000 r/min |
| Ball diameter D_w | 3.175 mm |
| Number of balls z | 26 |
| Reference grease quantity G_{ref} | 0.28 cm ³ |
| Preload class A G_A | 39 N |
| Static axial stiffness, preload class A | 76 N/ μ m |
| Preload class B G_B | 115 N |
| Static axial stiffness, preload class B | 119 N/ μ m |
| Preload class C G_C | 230 N |
| Static axial stiffness, preload class C | 161 N/ μ m |
| Calculation factor f | 1.18 |
| Calculation factor f_1 | 0.97 |
| Calculation factor f_{2A} | 1 |
| Calculation factor f_{2B} | 1.08 |
| Calculation factor f_{2C} | 1.15 |
| Calculation factor f_{HC} | 1 |



NUP BEARING LTD

| | |
|---|----------|
| Calculation factor e | 0.68 |
| Calculation factor (single, tandem) Y_2 | 0.87 |
| Calculation factor (single, tandem) Y_0 | 0.38 |
| Calculation factor (single, tandem) X_2 | 0.41 |
| Calculation factor (back-to-back, face-to-face) Y_1 | 0.92 |
| Calculation factor (back-to-back, face-to-face) Y_2 | 1.41 |
| Calculation factor (back-to-back, face-to-face) Y_0 | 0.76 |
| Calculation factor (back-to-back, face-to-face) X_2 | 0.67 |
| Mass bearing | 0.028 kg |