

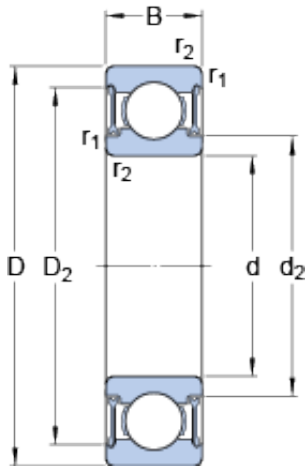

NUP BEARING LTD



35 mm x 80 mm x 21 mm skf W 6307-2RZ Deep groove ball bearings

Bearing No. W 6307-2RZ

W 6307-2RZ Bearing 2D drawings and 3D CAD models

Size	80x35x21 mm
Bore Diameter	80 mm
Outer Diameter	35 mm
Width	21 mm
d	35 mm
D	80 mm
B	21 mm
d ₂	46.78 mm
D ₂	71.58 mm
r _{1,2} - min.	1.5 mm
D _a - max.	72 mm
r _a - max.	1.5 mm
Basic dynamic load rating - C	28.6 kN
Basic static load rating - C ₀	19 kN
Fatigue load limit - P _u	0.815 kN
Reference speed	20000 r/min
Limiting speed	10000 r/min
Calculation factor - k _r	0.035
Calculation factor - f ₀	13.2
d ₂	46.78 mm
D ₂	71.58 mm
r _{1,2} min.	1.5 mm
d _a min.	43 mm
d _a max.	46.5 mm



NUP BEARING LTD

D_a max.	72 mm
r_a max.	1.5 mm
Basic dynamic load rating C	28.6 kN
Basic static load rating C_0	19 kN
Fatigue load limit P_u	0.815 kN
Calculation factor k_r	0.035
Calculation factor f_0	13.2
Mass bearing	0.44 kg